

# Wheel Stud & Brake Anchor Pin/ Bushings Service Kit # 16001

**\*\*READ ALL INSTRUCTIONS BEFORE OPERATING TOOL\*\***

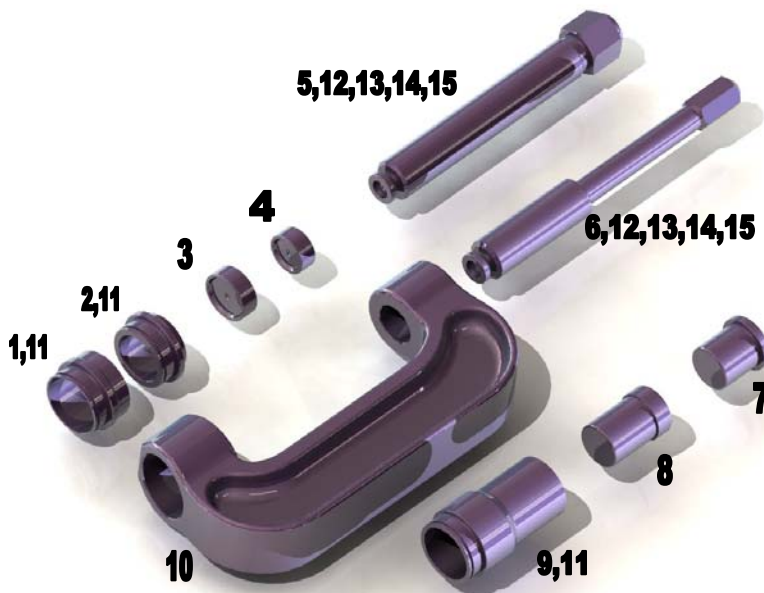

Item #	Part #	# Req'd	Description
1	16001-14	1	Large Stud Bushing
2	16001-13	1	Small Stud Bushing
3	16001-4	1	Large Stud Adapter
4	16001-3	1	Small Stud Adapter
5	16001-5	1	Wheel Stud Forcing Screw
6	16001-12	1	Anchor Pin Forcing Screw
7	16001-11	1	Bushing Installer
8	16001-10	1	Bushing Remover
9	16001-9	1	Spacer Tube
10	16001-1	1	Rigid C-Frame
11	10603-6	3	O-Ring 2-029
12	16001-6	2	Anvil
13	10803-9	2	Ball Bearing
14	16001-7	2	O-Ring 2-113
15	10202-4	2	Magnet

## WARNING!

- ALWAYS SET PARKING BRAKE AND BLOCK TIRES before working on vehicle. Never attempt to repair the vehicle while the engine is running.
- ALWAYS USE APPROVED IMPACT SAFETY GLASSES or goggles when working with this tool.
- ENSURE THE TOOL IS ALIGNED CORRECTLY before applying load to the screw.

Maintenance: Clean and lubricate with high quality oil (not anti-seize).

**TIGER TOOL**  
*International Incorporated*

**Product Support:**  
**1-800-661-4661**

**Call 1-800-661-4661 for technical questions or replacement parts**

### Wheel Stud Removal:

1. Select the wheel stud forcing screw (Item #5), and the stud bushing (Item #1 or 2) which best corresponds to the head of the wheel stud. Install them in the C-frame.
2. Select the stud adapter (Item #3 or 4), which best corresponds to the stud size, and place it on the magnetic end of the screw anvil.
3. With the assembly in place as shown in Figure 1, advance the forcing screw until the wheel stud is removed.

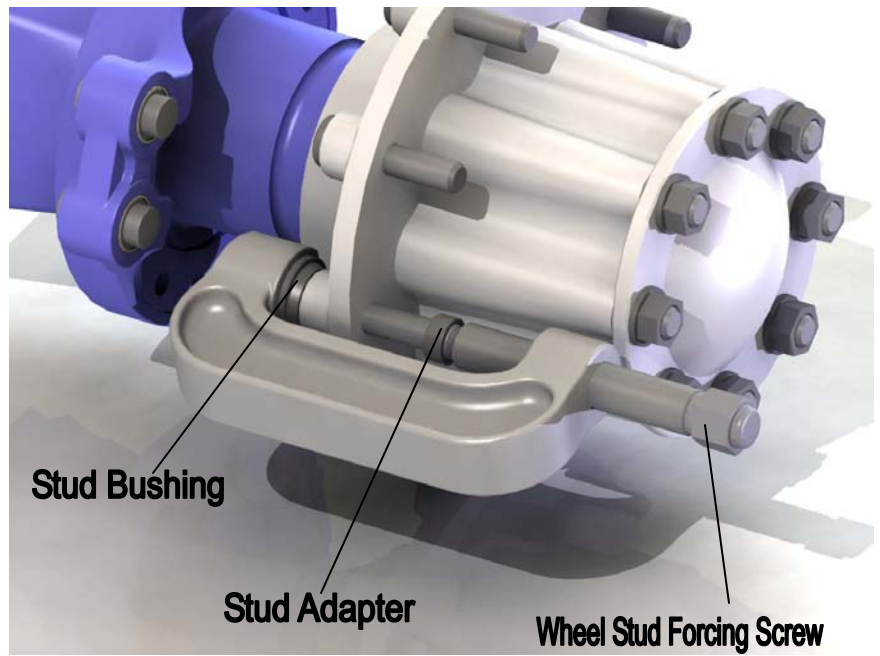

Figure 1

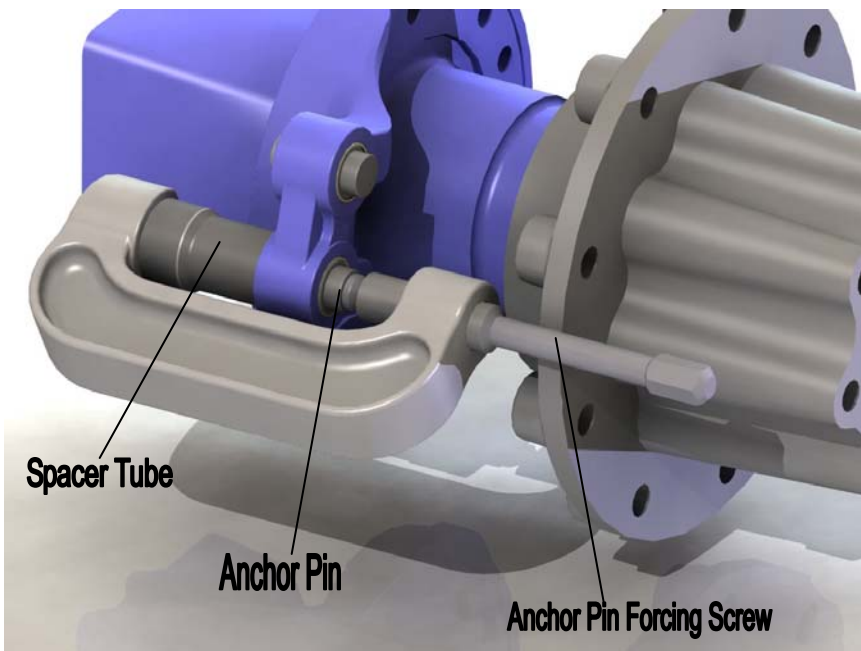

Figure 2

### Anchor Pin Removal:

1. Install the spacer tube (Item #9) and the anchor pin forcing screw (Item #6) in the C-frame.
2. Position the tool as shown in Figure 2. **\*CAUTION: the spacer tube (Item #9) MUST be concentric with the anchor pin to prevent interference when removing.** Advance the forcing screw until the anchor pin is removed.

### Bushing Removal:

1. Install the spacer tube (item #9) and the anchor pin forcing screw (Item #6) into the C-frame.
2. Place the bushing remover (Item #8) into the bushing in the spider.
3. Place the tool assembly over the bushing and the spider, so that the anvil locates in the recess on the bushing remover (see Figure 3).
4. Advance the forcing screw until the bushing is removed.

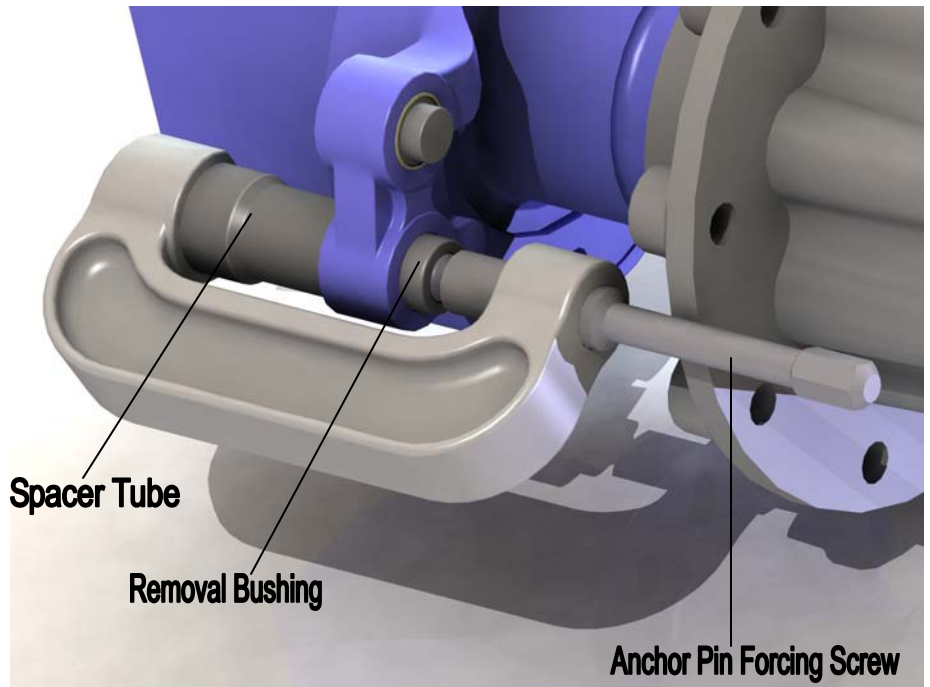

Figure 3

### Bushing Installation:

1. Install the spacer tube (item #9) and the anchor pin forcing screw (Item #6) into the C-frame.
2. Place the bushing installer (Item #7) over the magnetic anvil at the end of the forcing screw.
3. Slide the new bushing onto the bushing installer
4. Place the assembly over the spider with the bushing aligned with the hole (see Figure 4).
5. Advance the forcing screw until the flange on the bushing installer contacts the spider.

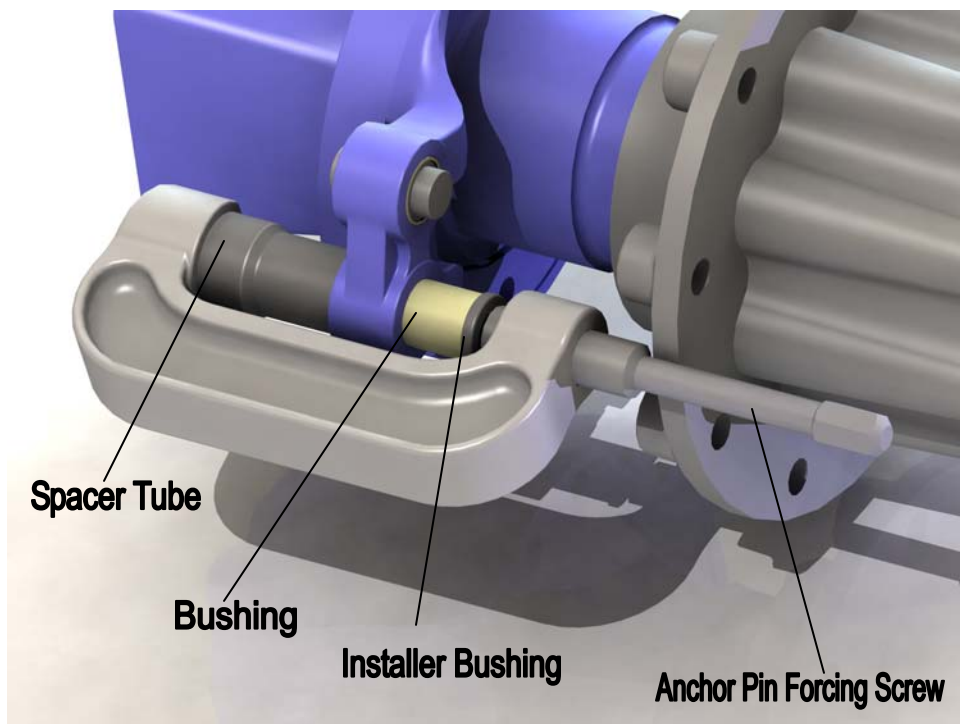

Figure 4